

Flange Units

UCFB2 (Normal-duty)

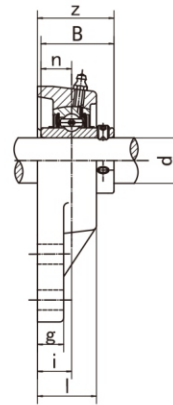
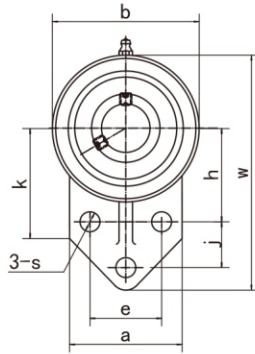

Unit NO.	Dimensions (mm / in.)															Bolt Size mm/in.	Bearing No.	Housing No.	Weight (kg)
	d	w	b	k	a	l	s	g	h	j	e	i	z	B	n				
UCFB201 201-8	12 1/2	110	62	52	52	25.5	10	13	42	27	32	15	33.3	31.0	12.7	M8	UC201	FB201	0.59
UC201-8	0.58																		
UCFB202 202-9 202-10	15 9/16 5/8	4-11/32	2-7/16	2-1/16	2-1/16	1	25/64	1/2	1-21/32	1-1/16	1-17/64	19/32	1-5/16	1.2205	0.500	5/16	UC202	FB202	0.58
UC202-9	0.58																		
UC202-10	0.58																UC203	FB203	0.57
UCFB203 203-11	17 11/16																UC203-11		0.56
UCFB204 204-12	20 3/4																UC204	FB204	0.55
UC204-12	0.55																UC204-12		0.55
UCFB205 205-13 205-14 205-15 205-16	25 13/16 7/8 15/16 1	116	68	52	56	27	10	13	45	27	34	16	35.8	34.1	14.3	M8	UC205	FB205	0.64
UC205-13	0.67																		
UC205-14	0.66	4-9/16	2-11/16	2-1/16	2-7/32	1-1/16	25/64	1/2	1-49/64	1-1/16	1-11/32	5/8	1-13/32	1.3425	0.563	5/16	UC205-14	0.66	
UC205-15	0.64																		
UC205-16	0.63																UC205-16	0.63	
UCFB206 206-17 206-18 206-19 206-20	30 1-1/16 1-1/8 1-3/16 1-1/4	130	78	55	65	31	10	13	50	29	40	18	40.2	38.1	15.9	M8	UC206	FB206	0.88
UC206-17	0.89																		
UC206-18	0.90	5-1/8	3-1/16	2-5/32	2-9/16	1-7/32	25/64	1/2	1-31/32	1-9/64	1-37/64	45/64	1-19/32	1.5000	0.626	5/16	UC206-18	0.88	
UC206-19	0.88																		
UC206-20	0.87																UC206-20	0.87	
UCFB207 207-20 207-21 207-22 207-23	35 1-1/4 1-5/16 1-3/8 1-7/16	144	90	62	70	34	10	15	55	32	46	19	44.4	42.9	17.5	M8	UC207	FB207	1.24
UC207-20	1.31																		
UC207-21	1.28	5-21/32	3-35/64	2-7/16	2-3/4	1-11/32	25/64	19/32	2-11/64	1-17/64	1-13/16	3/4	1-3/4	1.6890	0.689	5/16	UC207-21	1.28	
UC207-22	1.25																		
UC207-23	1.22																UC207-23	1.22	
UCFB208 208-24 208-25	40 1-1/2 1-9/16	164	100	72	78	36	12	16	60	41	50	21	51.2	49.2	19.0	M10	UC208	FB208	1.66
UC208-24	1.70																		
UC208-25	1.67	6-15/32	3-15/16	2-27/32	3-1/16	1-13/32	15/32	5/8	2-23/64	1-39/64	1-31/32	53/64	1-1/64	1.9370	0.748	3/8	UC208-25	1.67	
UCFB209 209-26 209-27 209-28	45 1-5/8 1-11/16 1-3/4	174	106	76	80	38	12	18	65	43	54	22	52.2	49.2	19.0	M10	UC209	FB209	1.92
UC209-26	2.02																		
UC209-27	1.98	6-27/32	4-3/16	3	3-5/32	1-1/2	15/32	23/32	2-9/16	1-11/16	2-1/8	55/64	2-1/16	1.9370	0.748	3/8	UC209-27	1.98	
UC209-28	1.94																		
UCFB210 210-29 210-30 210-31 210-32	50 1-13/16 1-7/8 1-15/16 2	184	112	82	86	40	12	18	68	46	58	22	54.6	51.6	19.0	M10	UC210	FB210	2.21
UC210-29	2.33																		
UC210-30	2.28	7-1/4	4-13/32	3-7/32	3-3/8	1-37/64	15/32	23/32	2-43/64	1-13/16	2-9/32	55/64	2-5/32	2.0315	0.748	3/8	UC210-30	2.28	
UC210-31	2.23																		
UC210-32	2.19																UC210-32	2.19	
UCFB211 211-32 211-33 211-34 211-35	55 2 2-1/16 2-1/8 2-3/16	207	130	86	90	43	14	18	78	50	62	25	58.4	55.6	22.2	M12	UC211	FB211	3.10
UC211-32	3.25																		
UC211-33	3.19	8-5/32	5-1/8	3-25/64	3-35/64	1-11/16	35/64	45/64	3-5/64	1-31/32	2-7/16	63/64	2-5/16	2.1890	0.874	7/16	UC211-33	3.19	
UC211-34	3.15																		
UC211-35	3.08																UC211-35	3.08	
UCFB212 212-36 212-37 212-38 212-39	60 2-1/4 2-5/16 2-3/8 2-7/16	223	140	90	94	48	14	18	84	55	66	29	68.7	65.1	25.4	M12	UC212	FB212	3.87
UC212-36	4.00																		
UC212-37	3.92	8-25/32	5-1/2	3-35/64	3-45/64	1-7/8	35/64	45/64	3-5/16	2-11/64	2-19/32	1-9/64	2-23/32	2.5630	1.000	7/16	UC212-37	3.92	
UC212-38	3.85																		
UC212-39	3.78																UC212-39	3.78	
UCFB213 213-40 213-41	65 2-1/2 2-9/16	244	155	94	100	50	14	20	92	60	70	30	69.7	65.1	25.4	M12	UC213	FB213	4.97
UC213-40	5.06																		
UC213-41	4.97	9-39/64	6-7/64	3-45/64	3-15/16	1-31/32	35/64	25/32	3-5/8	2-23/64	2-3/4	1-3/16	2-3/4	2.5630	1.000	7/16	UC213-40	5.06	