

16802+H

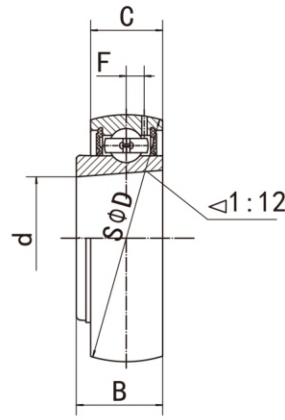

16802

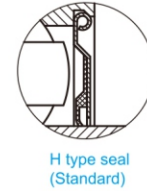

H type seal
(Standard)

Bearing NO.	Dimensions (mm / in.)									Dynamic load ratings (N)	Static load ratings (N)	Weight (kg)
	d ₁	d	D	B	C	B ₁	B ₂	d ₂	F			
1680204;H305	20	25	52	18	16	29	8	38	3.7	14000	7900	0.20
1680204;HE305	3/4	0.9843	2.0472	0.7087	0.6299	1.1417	0.315	1.496	0.146			
1680204;HA305	11/16											
1680205;H306	25	30	62	20	18	31	8	45	5.0	19400	11200	0.315
1680205;HE306	1	1.1811	2.4409	0.7874	0.7087	1.2205	0.315	1.772	0.197			
1680205;HA306	15/16											
1680205;HS306	7/8											
1680206;H307	30	35	72	22	20	35	9	52	5.7	25700	15200	0.47
1680206;HA307	1-3/16	1.3780	2.8346	0.8661	0.7874	1.3779	0.354	2.047	0.224			
1680206;HS307	1-1/8											
1680207;H308	35	40	80	23	21	36	10	58	5.9	29500	18100	0.59
1680207;HE308	1-1/4	1.5748	3.1496	0.9055	0.8268	1.417	0.394	2.283	0.2323			
1680207;HA308	1-5/16											
1680207;HS308	1-3/8											
1680208;H309	40	45	85	23	21	39	11	65	6.4	32700	20900	0.66
1680208;HE309	1-1/2	1.7717	3.3465	0.9055	0.8268	1.5354	0.433	2.559	0.252			
1680208;HA309	1-7/16											